

GAS DISTRIBUTION PRODUCTS

METER RISERS



Continental Industries

A Division of  **BURNDY** LLC

The Ultimate Connection
www.conind.com

ABOUT US

Our Company

Continental Industries, headquartered in Tulsa , Oklahoma , was formed in 1958 and is today a leading manufacturer of connectors for the Gas Utility, Gas & Water Distribution, Propane, Plumbing and Cathodic Protection markets. An ISO 9001 certified company, Continental Industries has manufacturing locations in Tulsa and Broken Arrow , Oklahoma. Our employees are committed to providing the best value to our customers.

Our full line of plastic and steel connector products are produced utilizing state-of-the-art injection molding machines, automatic screw machines, and CNC machining equipment. Our commitment to quality is evident in every step of our business processes. Renowned for our design and development of technologically advanced products, we provide our customers with reliable, cost-effective solutions to their "main to meter" service line installation, repair, or renewal problems.

thermOweld® , our exothermic welding materials and accessories products, provide a simple, efficient, cost effective method of permanently connecting two or more conductors utilizing a high temperature exothermic reaction between Aluminum and Copper Oxide to produce an almost pure copper weld. We manufacture all of our weld metal and molds in Oklahoma so you are certain of getting consistent, high quality products to satisfy your exothermic welding needs.

Our Vision

Simply stated, our vision is "To be a Sales and Customer Driven Company" . Our commitment to providing the best value to our customers is shared by the entire organization and is evidenced by both the number of long standing relationships we have gratefully developed over the years and the new relationships we are developing every day.

Why Use

Continental Industries is the industry leader in the manufacturing of plastic and steel mechanical fittings for the Gas & Water industry. From the Con-Stab ID Seal® to Scope®, steel saddles to HVT, quality and service is what drives us at Continental Industries.

Manufacturing fittings since 1958, Continental has the experience and confidence necessary to provide the best quality products on the market today. Continental Industries' mechanical fittings will save you both time and money and give you the peace of mind that comes with using a quality product.

Continental Industries' uses only the highest quality raw materials, engineered designs and manufacturing processes to ensure the consistent quality that makes Continental Industries' products second to none.

With regional sales offices located throughout the United States, a Continental Industries representative is only a phone call away to help with any questions you may have.

Come experience what so many other satisfied customers have experienced, the excitement and family atmosphere that is Continental Industries!

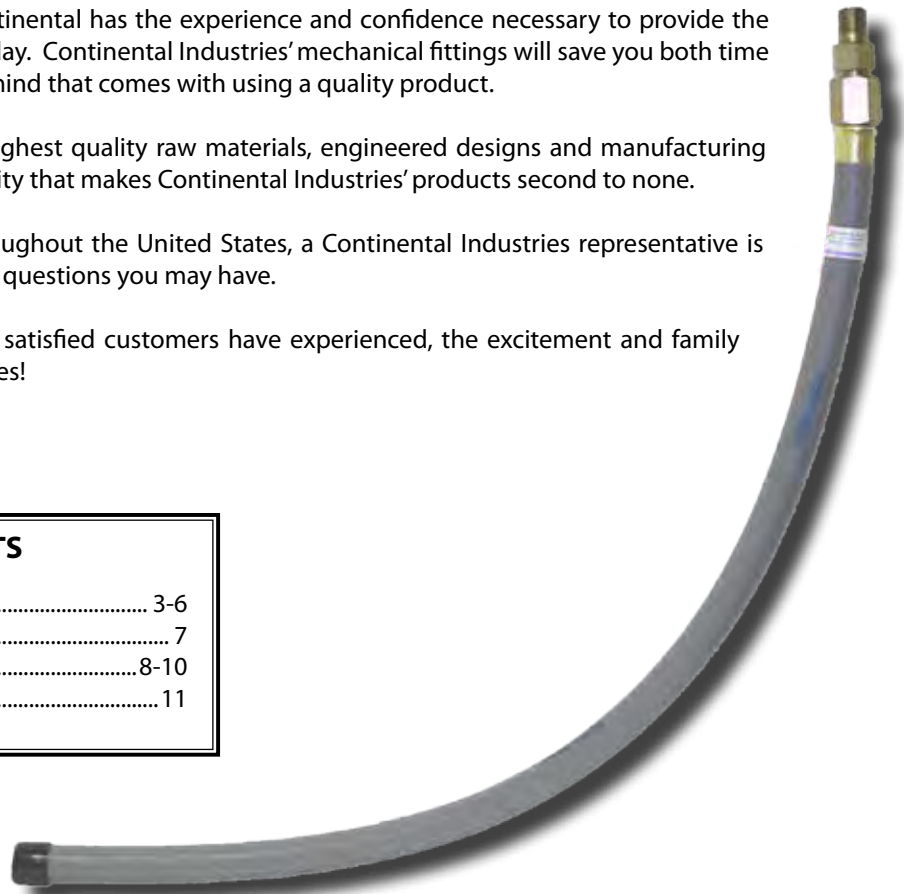

TABLE OF CONTENTS

Anodeless Meter Risers	3-6
Chamfer Tools	7
Flex Risers.....	8-10
Riser Brackets.....	11



ANODELESS METER RISERS

ANODELESS METER RISERS

ADVANTAGES

- Adapter machined from solid bar stock; not welded.
- Casing is TIG welded to adapter which provides a stronger and higher quality weld joint.
- Casing wall thickness exceeds ASTM requirements.
- Every part is leak tested.
- Bending performed through roll bending as opposed to rotary bending.
- Listed with IAPMO/UPC and CSA.

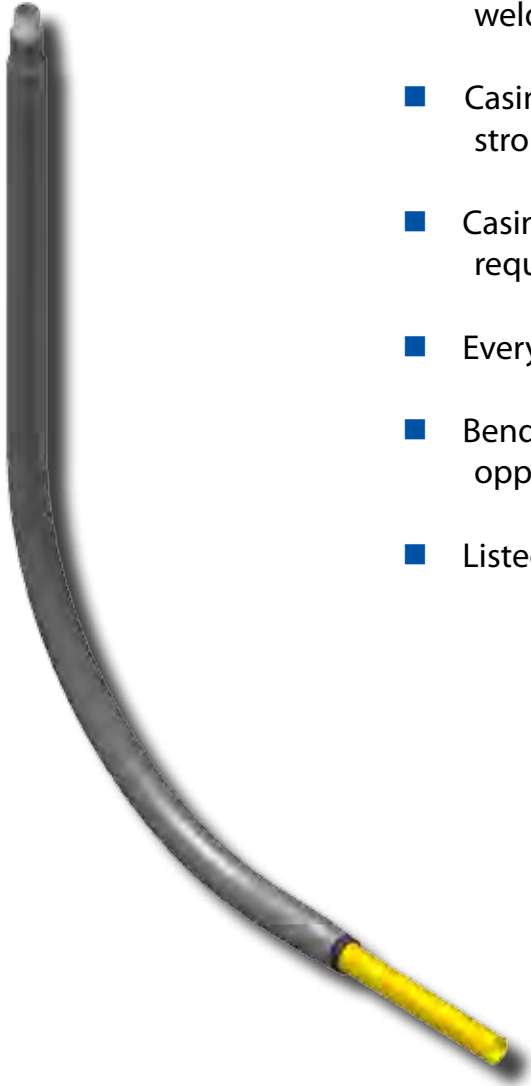

ANODELESS METER RISERS



ANODELESS METER RISERS

Specifications:

- Meets or exceeds all requirements for the Categorization of Mechanical Fittings within ASTM D2513 Category 1, and requirements from the Code of Federal Regulations, Title 49 part 192.281, 192.283 and 192.375.
- Meets or exceeds NFPA-58.
- Listed with IAPMO/UPC and CSA.
- Pipe Threads conform to ANSI B1.20.1.
- All Gas Carrying Steel parts meet or exceed ASTM A53.
- Casing Materials meet or exceed ASTM A 513.
- All polyethylene pipe and tubing components conform to ASTM D 2513.

National Pipe Thread
Meets ANSI B1.20.1

Primer Sealer
Urethane primer is a
moisture resistant sealant.

Steel Gas Carrier
Exceeds SCH 40
ASTM A53 grade pipe.

Above ground transition
fitting transfers gas from
polyethylene pipe to
steel nipple (100%
pressure tested).

Epoxy Coated
Steel Casing
Electrostatic bonded
coating process provides
long-term underground
corrosion protection.

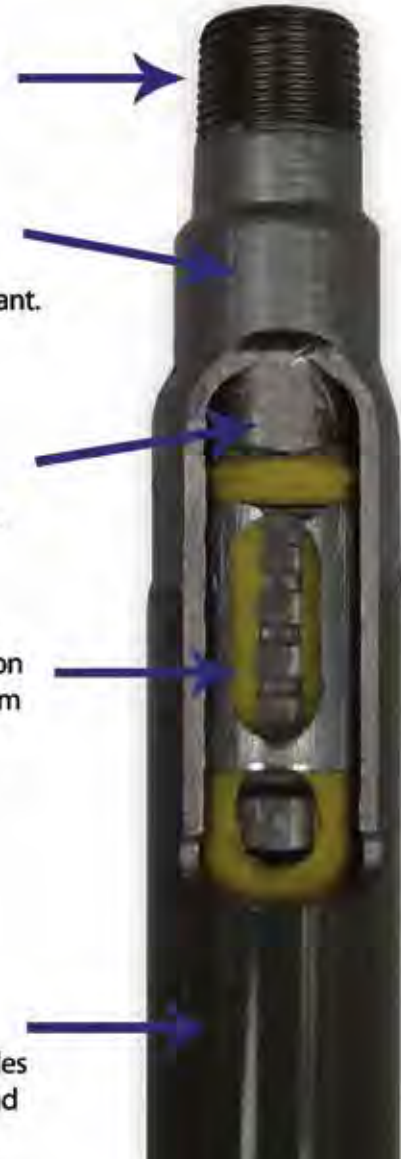



ANODELESS METER RISERS

ANODELESS METER RISERS

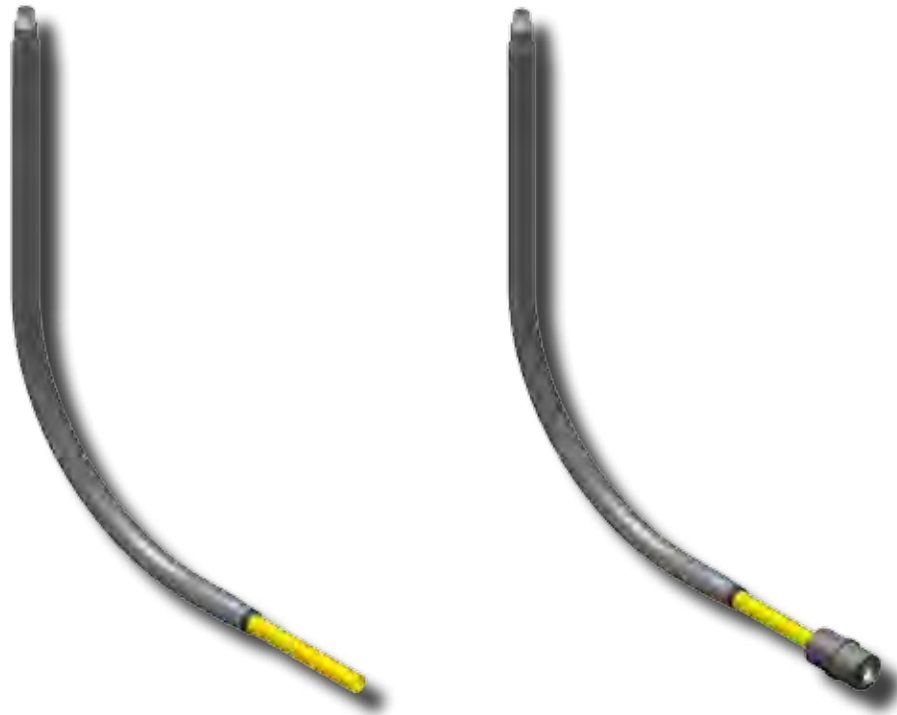

SIZE (MPT X PE)	WALL	VERTICAL LENGTH	HORIZONTAL LENGTH	PART NUMBER	PART NUMBER with Con-Stab
1/2" MPT X 1/2" CTS (5/8" OD) PE	.090	30"	15"	1253-91-4604-00†‡	1253-91-4604-25†‡
3/4" MPT X 1/2" CTS (5/8" OD) PE	.090	18"	19"	9953-99-0520-00†‡	9953-99-0521-00†‡
3/4" MPT X 1/2" CTS (5/8" OD) PE	.090	30"	17"	1353-91-4604-00†‡	1353-91-4604-25†‡
3/4" MPT X 1/2" IPS PE	SDR-9.3 (.090)	30"	17"	1353-91-4612-00‡	1353-91-4612-25
3/4" MPT X 3/4" IPS PE	SDR-11 (.095)	30"	16"	1353-91-4613-00†‡	1353-91-4613-25†‡
3/4" MPT X 1" CTS (1 1/8" OD) PE	.099/.101	30"	16"	1353-91-4608-00†‡	1353-91-4608-25‡
1" MPT X 1" CTS (1 1/8" OD) PE	.099/.101	30"	16"	1453-91-4608-00†‡	1453-91-4608-25†‡
1" MPT X 1" IPS PE	SDR-11 (.119)	30"	16"	1453-91-4614-00†‡	1453-91-4614-25†‡
1 1/4" MPT X 1 1/4" IPS PE	SDR-10 (.166)	30"	22"	1553-91-4615-00†‡	1553-91-4615-25†
1 1/4" MPT X 1 1/4" IPS PE	SDR-11 (.151)	30"	22"	1553-91-4615-0A†‡	9953-99-0503-25†
1 1/2" MPT X 1 1/2" IPS PE	SDR-11 (.173)	36"	26"	1652-91-4616-00†‡	1652-91-4616-25†‡
2" MPT X 2" IPS PE	SDR-11 (.216)	36"	30"	1752-91-4617-00†‡	1752-91-4617-25†

- **For sizes not listed, contact Continental Industries.**
- Pressure rating—Designed to meet or exceed pressure rating of PE pipe per 49 CFR Part 192 and ASTM D2513.
- Recommended accessories for Anodeless Meter Risers with Con-Stab ID Seal® Couplings;
 - Continental's Bladed Chamfering Tool. See below.
- Part numbers listed are for 2406 medium density polyethylene pipe. For part numbers with 3408 high density pipe, contact Continental Industries.
- † = CSA Approved / ‡ = IAPMO/UPC Listed

ANODELESS METER RISERS



ASSEMBLY INSTRUCTIONS : ID SEAL® CON-STAB

IMPORTANT

For use on: Polyethylene gas pipe meeting the requirements of ASTM D 2513
Pressure Rating: Designed to meet or exceed pressure rating of PE pipe per 49 CFR Part 192 and ASTM D 2513
Operating Temperature: -20 to 140° F

1 Verify the stab fitting is the correct size for the polyethylene (P.E.) pipe. Verify the SDR (or wall thickness) of the pipe matches the SDR (or wall thickness) printed on the fitting label.



2 Cut pipe ends square.



3 Clean piping thoroughly to assure there is no dirt, grease or oil in assembly area.



4a Chamfer end of pipe using [Continental's ID chamfering tool with ID gauge](#).

or



4b Chamfer end of pipe using [Continental's double ended ID chamfering tool](#).



5 Mark the stab depth by inserting pipe into ID chamfer tool and marking the pipe at the entrance as shown.



6 If using ID chamfer tool with gauge, check for proper chamfer by inserting pipe on gauge up to the o ring. With proper chamfer, o ring will begin to enter pipe.



7 Stab pipe completely into fitting entrance.



8 Stab pipe completely into fitting so that the mark on the pipe is within 1/8" from the fitting entrance.



9 Repeat steps 1 thru 8 for all Con-Stab joints.

10 To assure proper assembly and to comply with 49 CFR 192 Subpart J—Test Requirements, the joint shall be leak tested.



PATENT #'S 5,366,260, 5,692,785 & 5,853,272



CHAMFER TOOLS

ID CHAMFERING TOOLS To Be Used With Con-Stab ID Seal® Fittings

CATALOG NO.	DESCRIPTION
DOUBLE ENDED ID CHAMFER TOOLS	
0000-33-5647-00	1/2" IPS X 1/2" CTS (5/8" OD)
0000-33-5481-00	3/4" IPS X 1/2" CTS (5/8" OD)
0000-33-5652-00	3/4" IPS X 1/2" IPS
0000-33-5480-00	1" CTS (1 1/8" OD) X 1/2" CTS (5/8" OD)
0000-33-5963-00	1" CTS (1 1/8" OD) X 1/2" IPS
0000-33-5763-00	1" CTS (1 1/8" OD) X 3/4" CTS (7/8" OD)
0000-33-5589-00	1" CTS (1 1/8" OD) X 3/4" IPS
0000-33-5514-00	1" IPS X 1/2" CTS (5/8" OD)
0000-33-5516-00	1" IPS X 3/4" IPS
0000-33-5606-00	1" IPS X 1" CTS (1 1/8" OD)
ID CHAMFER TOOL SWITH GAUGE	
0000-33-6580-04	1/2" CTS (5/8" OD) .090 WALL
0000-33-6580-08	1" CTS (1 1/8" OD) .099/.101 WALL
0000-33-6580-12	1/2" IPS SDR-3
0000-33-6580-13	3/4" IPS SDR-11
0000-33-6580-14	1" IPS SDR-11
0000-33-6580-15	1 1/4" IPS SDR-10 (.166 WALL)
0000-33-6580-10	1 1/4" IPS SDR-11 (.151 WALL)
0000-33-6580-16	1 1/2" IPS SDR-11
0000-33-6580-17	2" IPS SDR-11



Continental Can Provide For All Of Your Main To Meter Connection Needs



CONFLEX RISERS



CONFLEX RISERS

- ▶ ConFlex Risers are designed to meet or exceed pressure rating of PE pipe per 49 CFR Part 192 and ASTM D2513..
- ▶ ConFlex Risers conform to trench depth and flex with ground movement.
- ▶ ConFlex Risers may be installed with or without meter set present.
- ▶ ConFlex Risers have a swivel feature to allow tightening the Service Head Adapter without turning the flex hose.
- ▶ Service Head Adapter design has been used in the natural gas industry since 1967.
 - ▶ The Service Head Adapter offers a simple and dependable installation method.
 - ▶ The stiffener is integral to the adapter coupling. It does not fall out. No loose components.
 - ▶ The Service Head Adapter design is listed by IAPMO and CSA.
 - ▶ Service Head Adapter meets the requirements of ASTM F 1948 and ASTM D 2513.
- ▶ ConFlex Risers meet the requirements of;
 - ▶ ASTM D 2513
 - ▶ D.O.T. Title 49 of the Code of Federal Regulations, Part 192.283 (b) and 192.375.
 - ▶ NFPA 54 & NFPA 58
 - ▶ ConFlex Risers have a moisture seal as required in NFPA 54 & NFPA 58.
 - ▶ The Flex Hose meets 300 lb tensile requirement and 1000 lb crush requirement stated in NFPA 58.
 - ▶ The Flex Hose to Service Head Adapter joint meets 300 lb tensile requirement stated in NFPA 58.
 - ▶ Liner Sleeve provided to meet requirements of NFPA 58.
- ▶ IAPMO and CSA Listed.

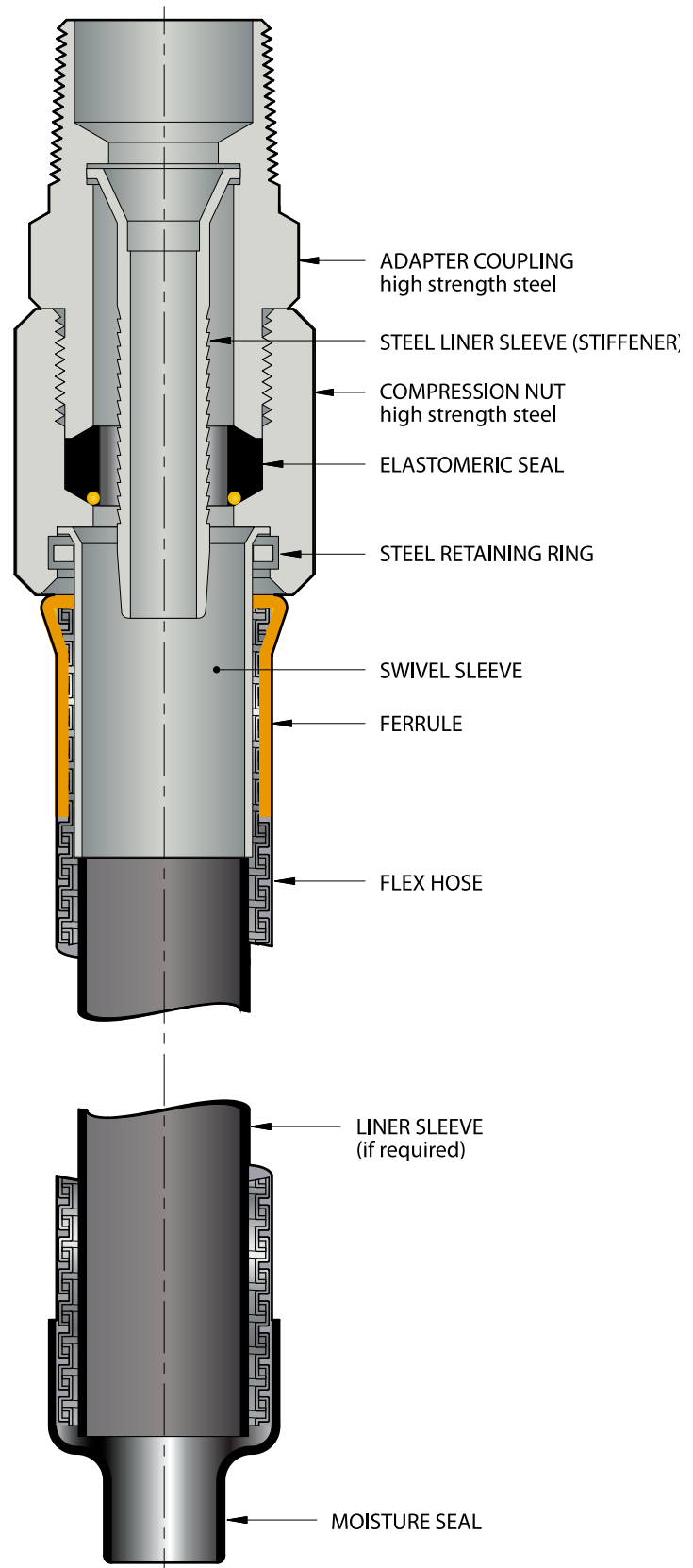



CONFLEX RISERS

CONFLEX RISERS



SIZE (MPT X PE)	WALL	LENGTH	PART NUMBER w/ Liner Sleeve	PART NUMBER w/o Liner Sleeve
1/2" MPT X 1/2" CTS (5/8" OD) PE	.090	36"	1253-92-1004-36†‡	1253-96-1004-36†
		60"	1253-92-1004-60†‡	1253-96-1004-60†
		72"	1253-92-1004-72†‡	1253-96-1004-72†
		84"	1253-92-1004-84†‡	1253-96-1004-84†
		96"	1253-92-1004-96†‡	1253-96-1004-96†
3/4" MPT X 1/2" CTS (5/8" OD) PE	.090	36"	1353-92-1004-36†‡	1353-96-1004-36†
		60"	1353-92-1004-60†‡	1353-96-1004-60†
		72"	1353-92-1004-72†‡	1353-96-1004-72†
		84"	1353-92-1004-84†‡	1353-96-1004-84†
		96"	1353-92-1004-96†‡	1353-96-1004-96†
1" MPT X 1/2" CTS (5/8" OD) PE	.090	36"	1453-92-1004-36†‡	1453-96-1004-36†
		60"	1453-92-1004-60†‡	1453-96-1004-60†
		72"	1453-92-1004-72†‡	1453-96-1004-72†
		84"	1453-92-1004-84†‡	1453-96-1004-84†
		96"	1453-92-1004-96†‡	1453-96-1004-96†
3/4" MPT X 3/4" CTS (7/8" OD) PE	.090	36"	1353-92-1006-36	1353-96-1006-36
		60"	1353-92-1006-60	1353-96-1006-60
		72"	1353-92-1006-72	1353-96-1006-72
		84"	1353-92-1006-84	1353-96-1006-84
		96"	1353-92-1006-96	1353-96-1006-96
1" MPT X 3/4" CTS (7/8" OD) PE	.090	36"	1453-92-1006-36	1453-96-1006-36
		60"	1453-92-1006-60	1453-96-1006-60
		72"	1453-92-1006-72	1453-96-1006-72
		84"	1453-92-1006-84	1453-96-1006-84
		96"	1453-92-1006-96	1453-96-1006-96
3/4" MPT X 1" CTS (1 1/8" OD) PE	.099/.101	36"	1353-92-1008-36†‡	1353-96-1008-36†
		60"	1353-92-1008-60†‡	1353-96-1008-60†
		72"	1353-92-1008-72†‡	1353-96-1008-72†
		84"	1353-92-1008-84†‡	1353-96-1008-84†
		96"	1353-92-1008-96†‡	1353-96-1008-96†
1" MPT X 1" CTS (1 1/8" OD) PE	.099/.101	36"	1453-92-1008-36†‡	1453-96-1008-36†
		60"	1453-92-1008-60†‡	1453-96-1008-60†
		72"	1453-92-1008-72†‡	1453-96-1008-72†
		84"	1453-92-1008-84†‡	1453-96-1008-84†
		96"	1453-92-1008-96†‡	1453-96-1008-96†
1 1/4" MPT X 1" CTS (1 1/8" OD) PE	.099/.101	36"	1553-92-1008-36†‡	1553-96-1008-36†
		60"	1553-92-1008-60†‡	1553-96-1008-60†
		72"	1553-92-1008-72†‡	1553-96-1008-72†
		84"	1553-92-1008-84†‡	1553-96-1008-84†
		96"	1553-92-1008-96†‡	1553-96-1008-96†

- For sizes not listed, contact Continental Industries.
- Pressure rating—Designed to meet or exceed pressure rating of PE pipe per 49 CFR Part 192 and ASTM D2513.
- † = CSA Approved / ‡ = IAPMO/UPC Listed
- Installation Instructions provided with each riser or visit www.conind.com for installation instructions.

CONFLEX RISERS



CONFLEX RISERS



SIZE (MPT X PE)	WALL	LENGTH	PART NUMBER w/ Liner Sleeve	PART NUMBER w/o Liner Sleeve
1/2" MPT X 1/2" IPS PE	SDR-9.3 (.090)	36"	1253-92-1012-36†	1253-96-1012-36
		60"	1253-92-1012-60†	1253-96-1012-60
		72"	1253-92-1012-72†	1253-96-1012-72
		84"	1253-92-1012-84†	1253-96-1012-84
		96"	1253-92-1012-96†	1253-96-1012-96
3/4" MPT X 1/2" IPS PE	SDR-9.3 (.090)	36"	1353-92-1012-36‡	1353-96-1012-36
		60"	1353-92-1012-60‡	1353-96-1012-60
		72"	1353-92-1012-72‡	1353-96-1012-72
		84"	1353-92-1012-84‡	1353-96-1012-84
		96"	1353-92-1012-96‡	1353-96-1012-96
1" MPT X 1/2" IPS PE	SDR-9.3 (.090)	36"	1453-92-1012-36 ‡	1453-96-1012-36
		60"	1453-92-1012-60 ‡	1453-96-1012-60
		72"	1453-92-1012-72 ‡	1453-96-1012-72
		84"	1453-92-1012-84 ‡	1453-96-1012-84
		96"	1453-92-1012-96 ‡	1453-96-1012-96
3/4" MPT X 3/4" IPS PE	SDR-11 (.095)	36"	1353-92-1013-36†‡	1353-96-1013-36†
		60"	1353-92-1013-60†‡	1353-96-1013-60†
		72"	1353-92-1013-72†‡	1353-96-1013-72†
		84"	1353-92-1013-84†‡	1353-96-1013-84†
		96"	1353-92-1013-96†‡	1353-96-1013-96†
1" MPT X 3/4" IPS PE	SDR-11 (.095)	36"	1453-92-1013-36†‡	1453-96-1013-36†
		60"	1453-92-1013-60†‡	1453-96-1013-60†
		72"	1453-92-1013-72†‡	1453-96-1013-72†
		84"	1453-92-1013-84†‡	1453-96-1013-84†
		96"	1453-92-1013-96†‡	1453-96-1013-96†
1" MPT X 1" IPS PE	SDR-11 (.119)	36"	1453-92-1014-36‡	1453-96-1014-36
		60"	1453-92-1014-60‡	1453-96-1014-60
		72"	1453-92-1014-72‡	1453-96-1014-72
		84"	1453-92-1014-84‡	1453-96-1014-84
		96"	1453-92-1014-96‡	1453-96-1014-96
1 1/4" MPT X 1 1/4" IPS PE	SDR-10 (.116)	36"	N/A	1553-96-1015-36†‡
	SDR-11 (.151)	36"	N/A	9953-99-0445-00
1 1/2" MPT X 1 1/2" IPS PE	SDR-11 (.173)	36"	N/A	1653-96-1016-36
2" MPT X 2" IPS PE	SDR-11 (.216)	36"	N/A	1753-96-1017-36

- For sizes not listed, contact Continental Industries.
- Pressure rating—Designed to meet or exceed pressure rating of PE pipe per 49 CFR Part 192 and ASTM D2513.
- † = CSA Approved / ‡ = IAPMO/UPC Listed
- Installation Instructions provided with each riser or visit www.conind.com for installation instructions.



CONFLEX RISERS

RISER BRACKETS



17-6133-00
6" Stand-Off

- (2) 3/8" wide x 2" long angular mounting slots
- Accommodates 1/2" thru 1 1/4" flex risers
- Powder coated finish
- Mounting hardware included



17-6134-00
9" Stand-Off

- (2) 3/8" wide x 2" long angular mounting slots
- Accommodates 1/2" thru 1 1/4" flex risers
- Powder coated finish
- Mounting hardware included



17-6134-01
9" Stand-Off

- Accommodates 1/2" thru 1 1/4" flex risers
- Powder coated finish
- Mounting hardware included

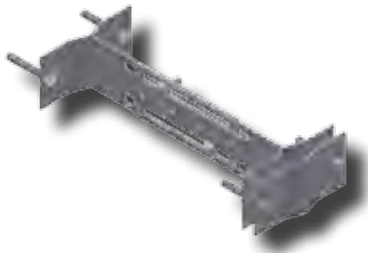

17-6135-00
Universal Riser Bracket

- Can be used for virtually any mounting situation
- Foundation, single or double remote installations
- Accommodates 1/2" thru 2" risers
- Carriage bolts supplied for ease of assembly
- Powder coated finish
- Foundation mounting hardware included
- (2) 3/8 wide x 1-5/8 straight mounting slots (Drivepost shown sold separately)

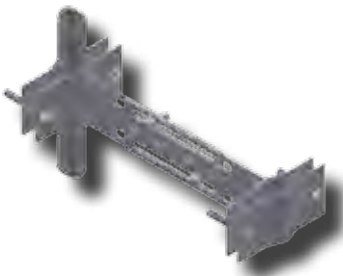

OTHER QUALITY PRODUCTS FROM CONTINENTAL INDUSTRIES

GAS DISTRIBUTION PRODUCTS
**CON-STAB ID SEAL®
FITTINGS**



Con-Stab ID Seal® Fittings

GAS DISTRIBUTION PRODUCTS
**MECHANICAL
SADDLES & FITTINGS**



Mechanical
Saddles & Fittings

GAS DISTRIBUTION PRODUCTS
STEEL SERVICE TEES



Steel Service Tees

GAS DISTRIBUTION PRODUCTS
**STEEL
COUPLINGS**



Steel Couplings

GAS DISTRIBUTION PRODUCTS
TRANSITION FITTINGS



Transition Fittings

GAS DISTRIBUTION PRODUCTS
**EFV FITTING
CATALOG**



EFV Catalog

GAS DISTRIBUTION PRODUCTS
**IN-LINE REPAIR
FITTINGS**



FROM STANDARD TO SPECIALS,
CONTINENTAL INDUSTRIES HAS YOUR IN-LINE REPAIR FITTING.
NO OTHER SINGLE MANUFACTURER CAN OFFER THE VARIETY
OF REPAIR FITTINGS THAT
CONTINENTAL INDUSTRIES PROVIDES.



In-Line Repair Fittings

WATER DISTRIBUTION PRODUCTS
PVC WATER FITTINGS



PVC Water Fittings

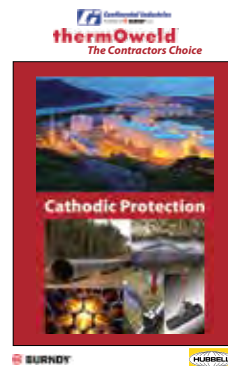

thermOweld® for
Cathodic Protection



CONTINENTAL INDUSTRIES

1140 North 129th East Ave. Tulsa, Oklahoma 74116

(Phone) 800-558-1373 or 918-627-5210

(Fax) 800-788-1668 or 918-622-1275

www.conind.com

The Ultimate Connection